

Introducing NX Mold, Tool and Die Solutions

Why NX as a Technology Platform?



NX is built on the most modern architecture of any major CAD/CAM/CAE solution

Every NX release is customer deployment ready

NX is an open solution that “plugs and plays” with your existing IT systems

NX enables you to use data from previous NX and Unigraphics releases in the current release

- Goes back to the first Unigraphics release (circa 1984)

Proven Deployment	Data Preservation
Platform Flexibility	Scalable

NX: Breaking down the barriers to innovation

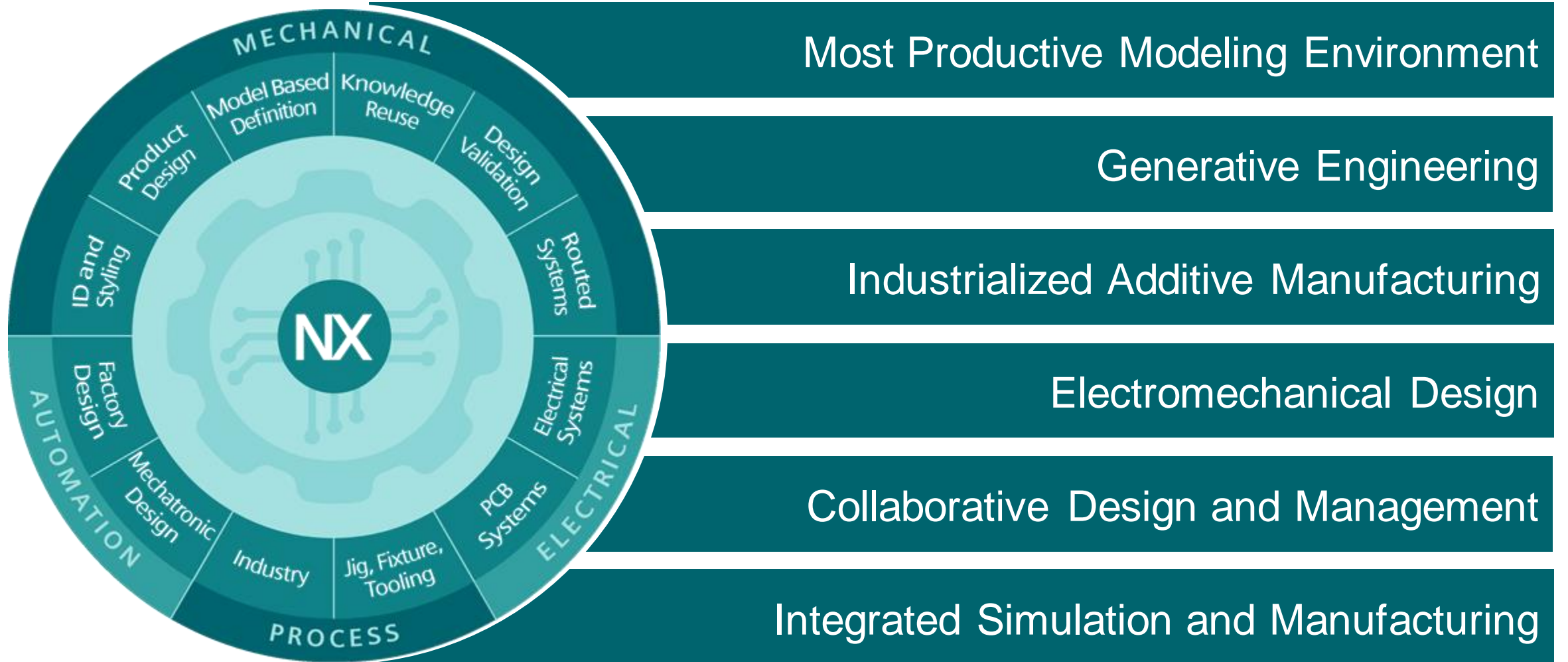

Tooling manufacturing – a vital industrial sector

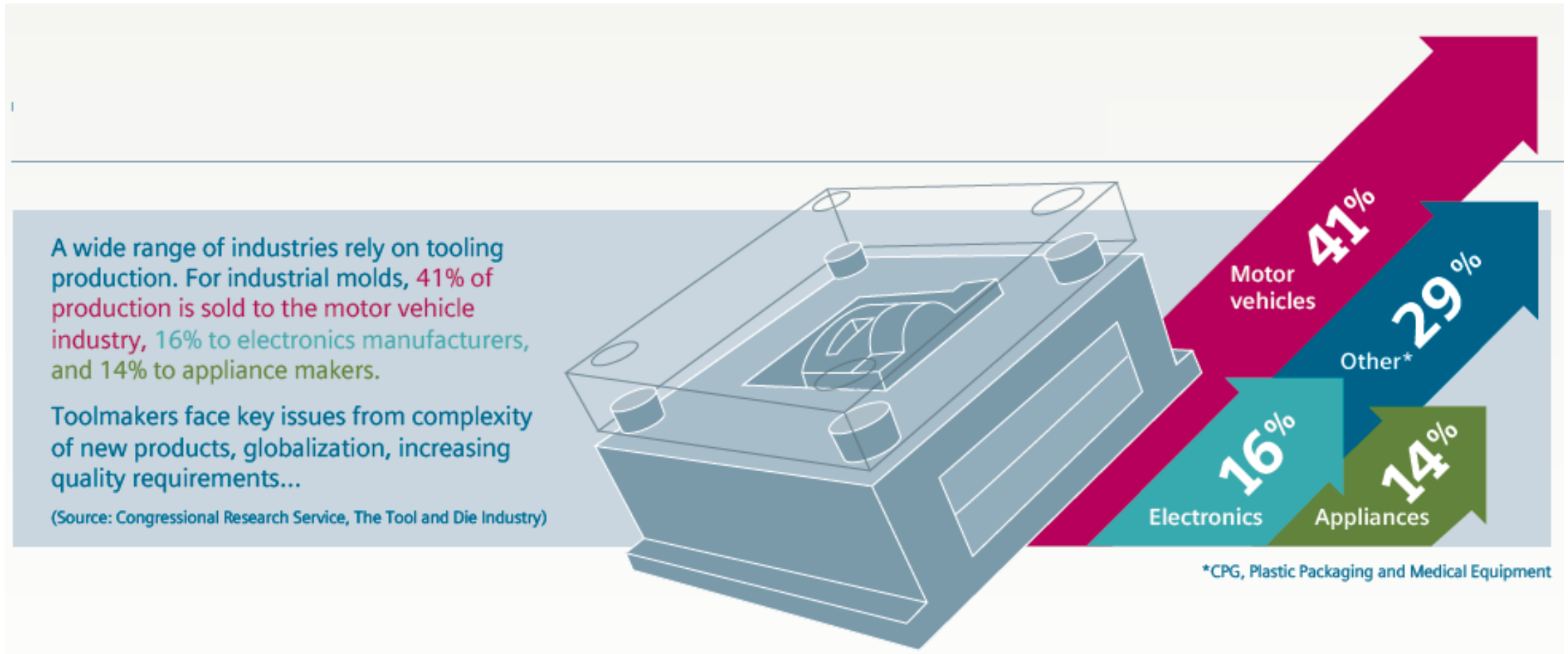

Tooling industry challenges



Tool quality and upfront feasibility are more important than price among tier 1 suppliers.

(Source: OESA/HRI Barometer)

65% of tooling manufacturers intend to invest in more CNC automation to improve quality and lead time.

(Source: Harbor IQ Quarterly)

Tooling industry trends

Early Supplier Involvement

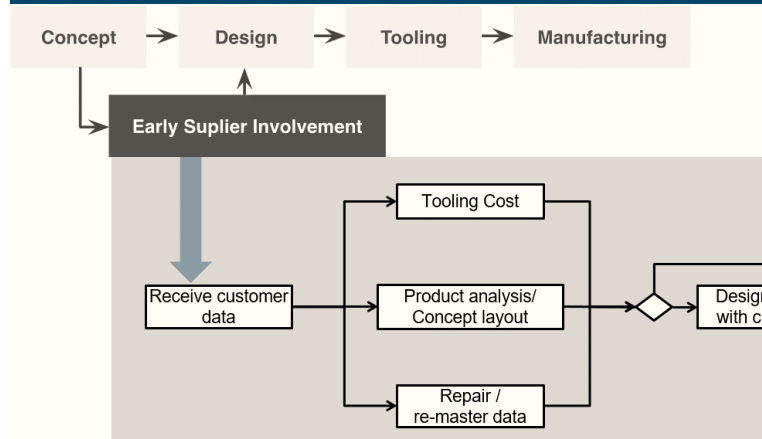

Improve collaboration with customers/OEMs

Process Automation

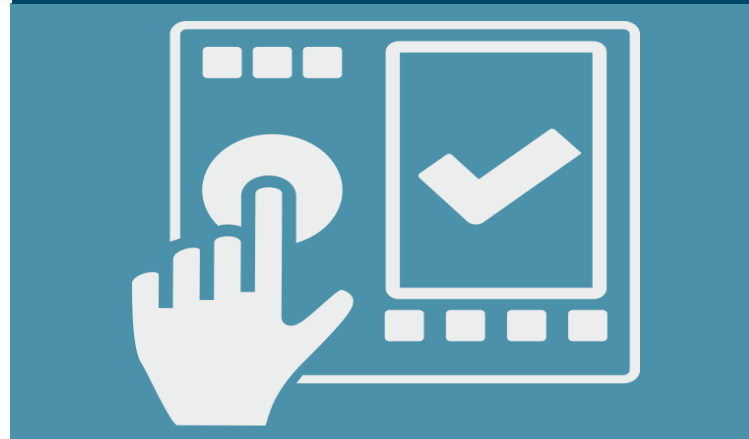

Capture and reuse your best practices

Additive Manufacturing

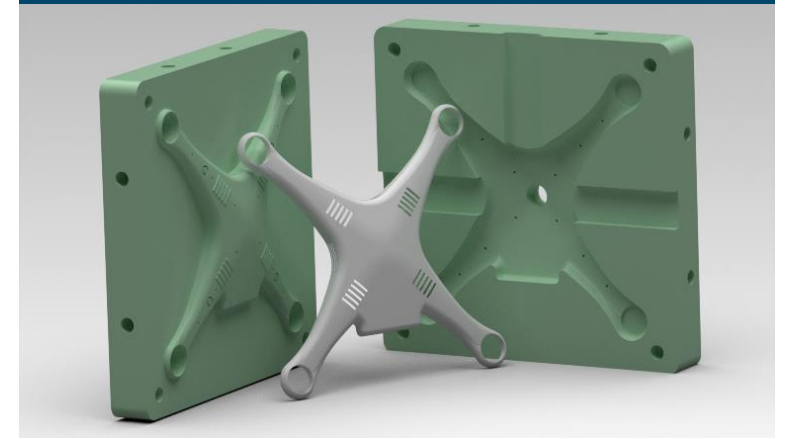

Accelerate prototyping and improve mold performance

Key benefits of NX (Mold, Tool and Die Solutions)

- Helps address challenges faced by every tool shops
- NX offers a complete, integrated solution - “all in one system”
 - One system, one vendor
 - Automated every tasks involved in mold design and mfg. process
 - Solid connection between functions
 - Easy to handle design changes
 - Expandable > data management, shop floor data distribution.....

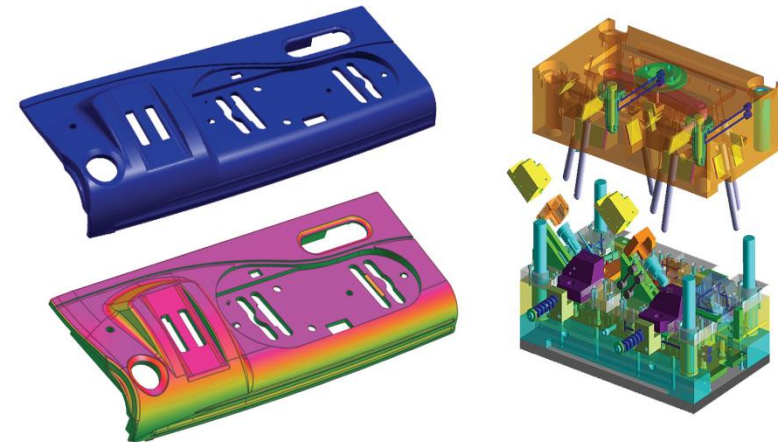

Typical Mold and Die Tools

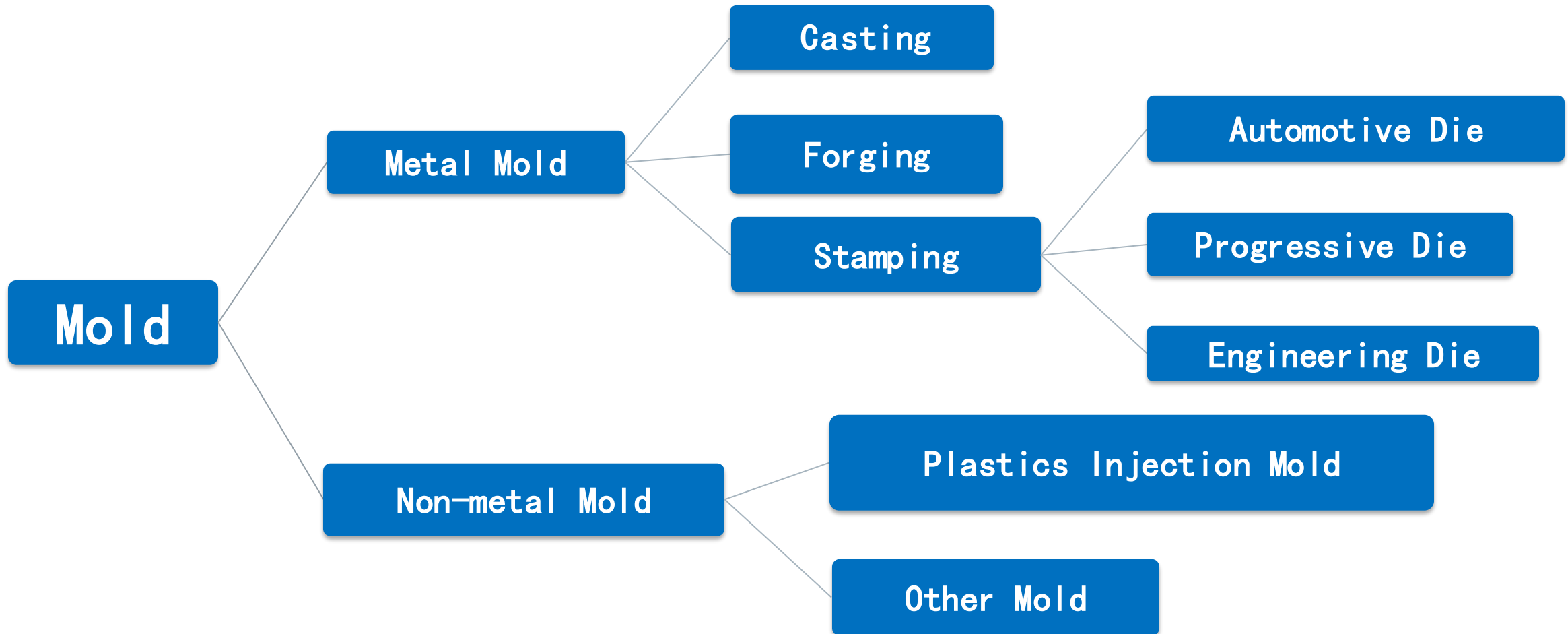

Siemens Solutions Tool Design

SIEMENS
Ingenuity for life

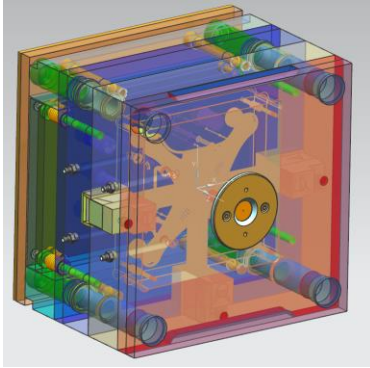

Mold Wizard

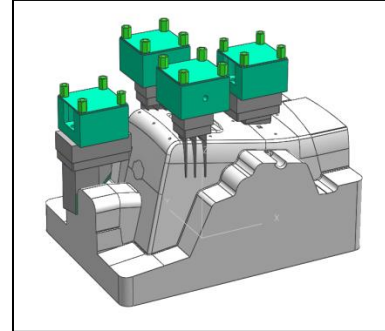

Electrode Wizard

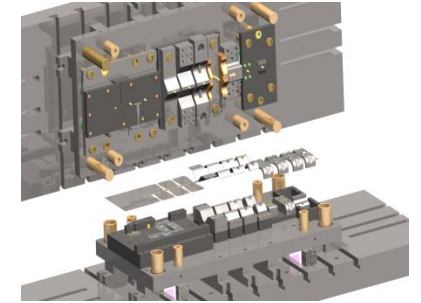

Progressive Die Wizard

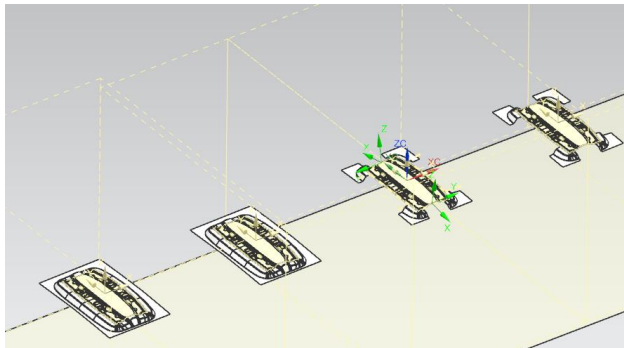

Die Engineering

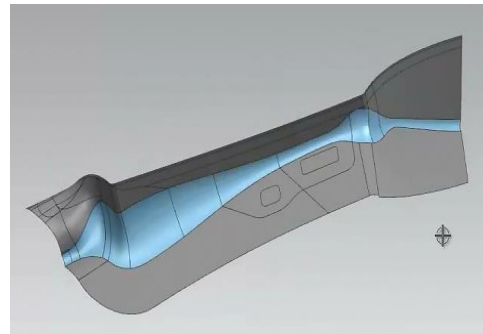

Flow Blend for NX

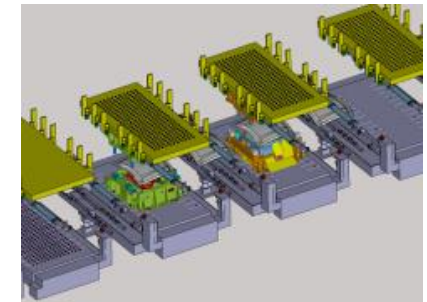

Die Structure Design

Siemens Solutions NX Mold Wizard Coverage

SIEMENS
Ingenuity for life



Siemens Solutions NX Progressive Die Wizard Coverage

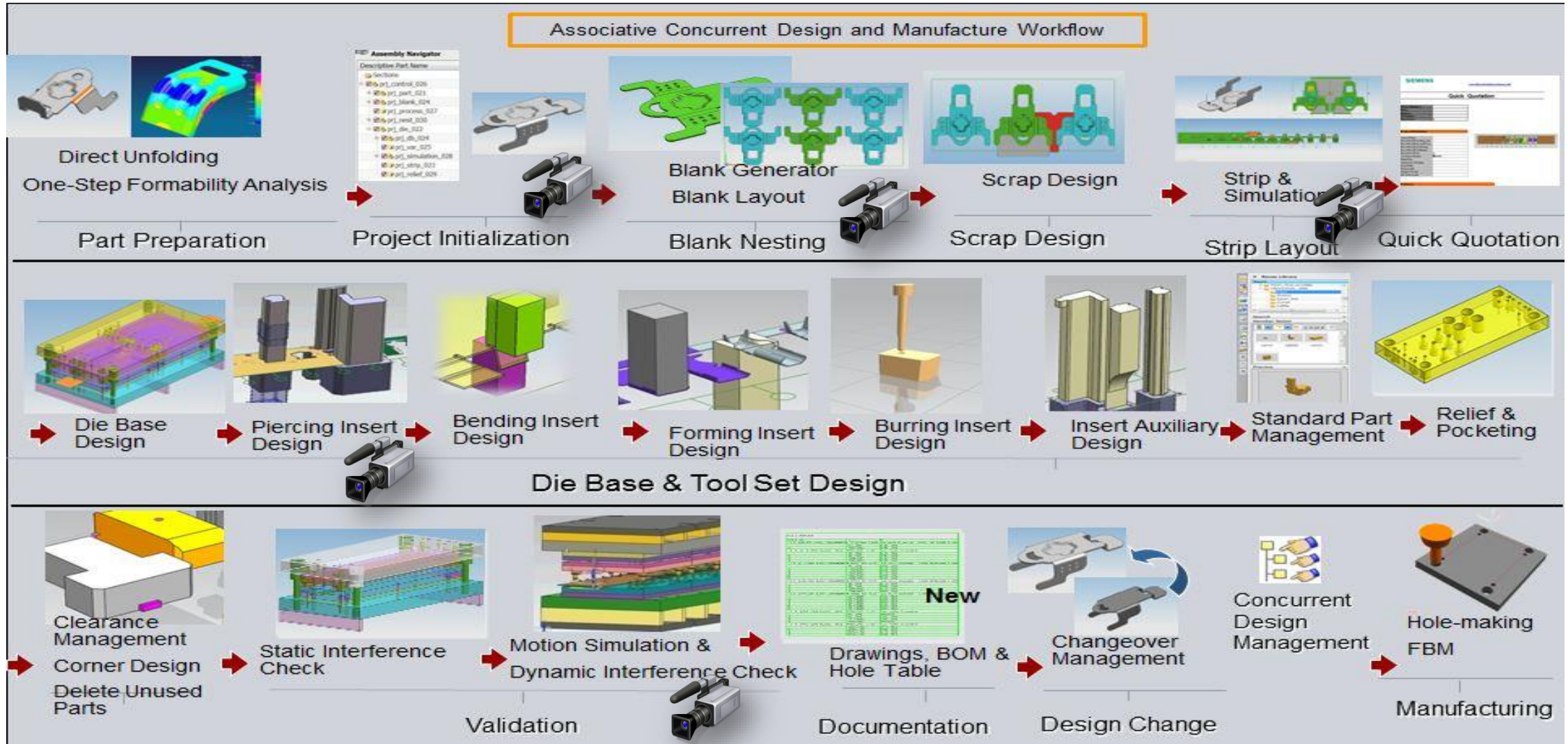

Siemens Solutions NX Automotive Stamping Die Design Wizards Coverage

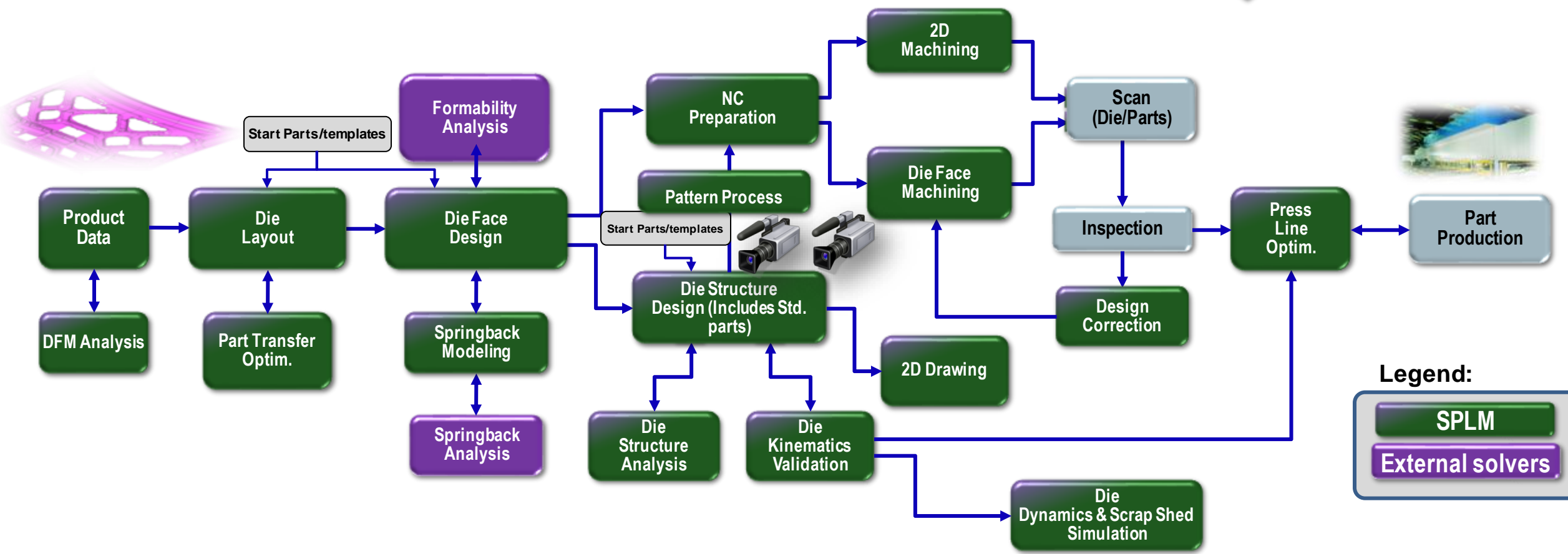

Siemens Solutions

NX Electrode Manufacturing Solutions

SIEMENS
Ingenuity for life

Electrode Design

Electrode Machining

Electrode
Measurements

EDM

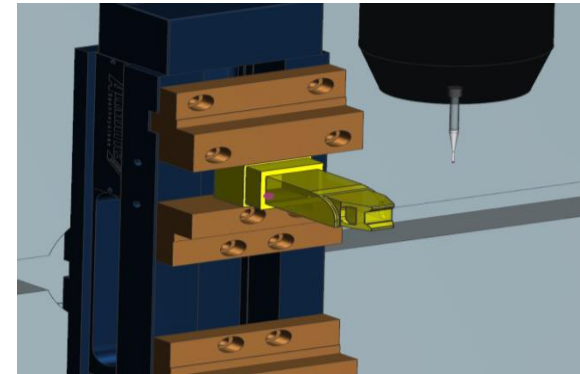
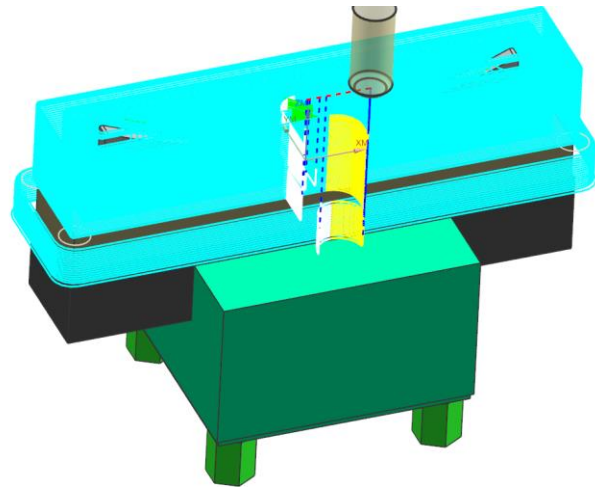
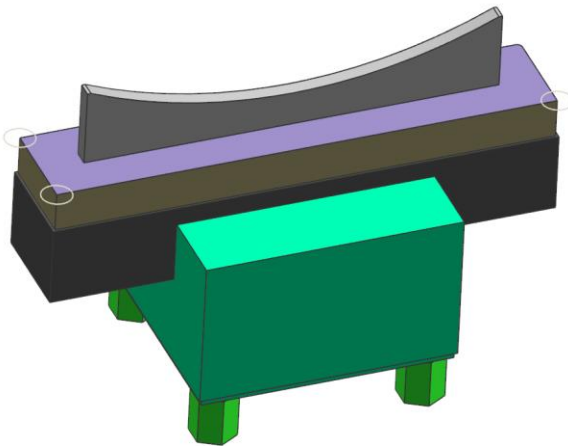

Siemens Solutions Tool Validation

SIEMENS
Ingenuity for life

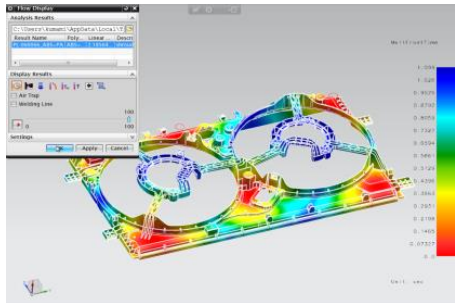

**EasyFill (mold Flow)
Analysis**

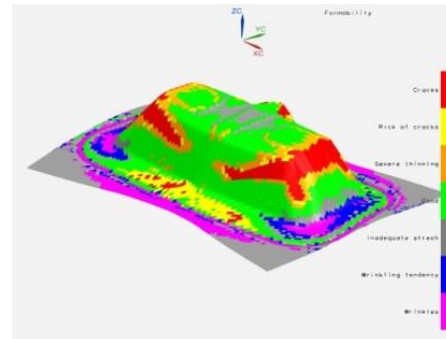

**One-Step formability
Analysis (Stamping)**

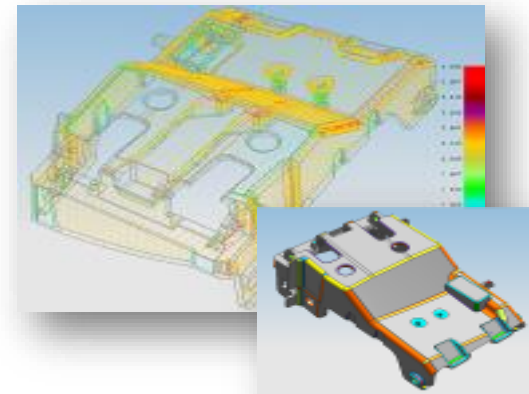

**Draft, wall thickness,
tool motion, etc**

Available as part of NX Mold
Wizard, NX Progressive Die
Wizard



Press Die Checker

Siemens Solutions Machining

SIEMENS
Ingenuity for life

- 2 ½ axis milling
- Drilling – manual and automated
- 3 axis (fixed axis) milling
- 5 axis milling
- Turning
- Wire EDM
- EDM Sinking
- Electrode machining
- Feature based prog.
- Machining simulation
- Machine data and tool libraries

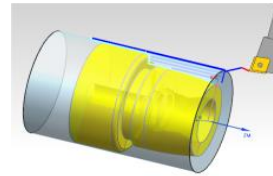

Turning

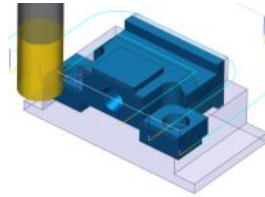

2 ½ axis milling

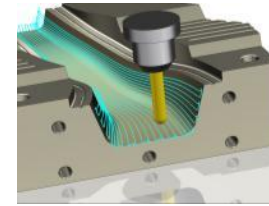

3 axis milling

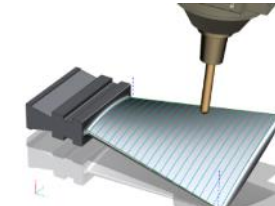

5 axis milling



**Turbo machinery
milling**

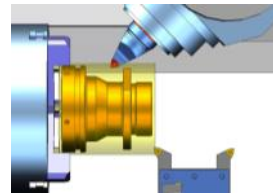

Mill turn

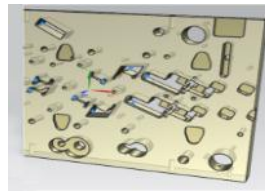

Wire EDM 2 & 4 axis

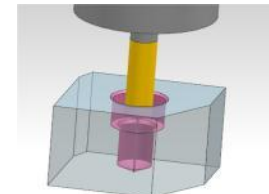

Hole making

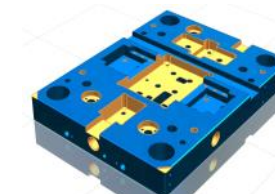

**Feature based
machining**

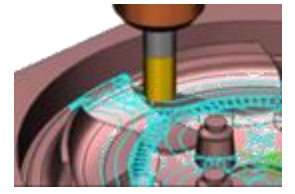

High speed milling

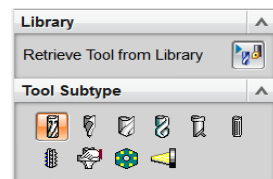

Tool libraries



**Shop floor
documents**

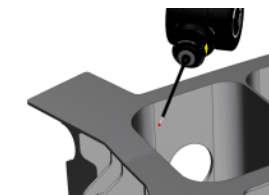

**On machine
probing**

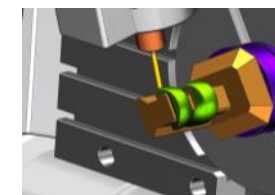

**Machine tool
simulation**



Post processing

Efficiency in Mold Design

Cavalier Tool and Manufacturing

SIEMENS
Ingenuity for life

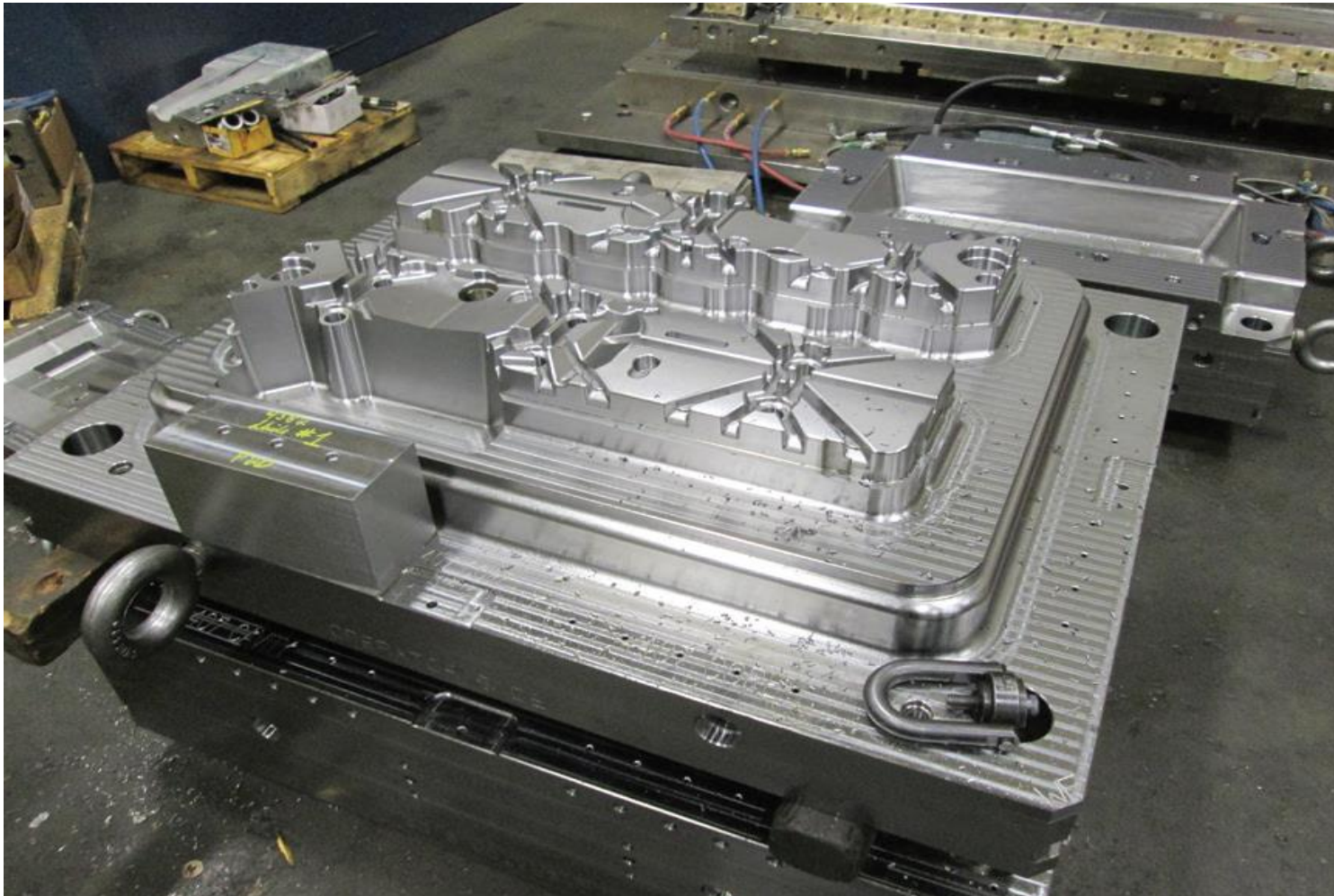

**Award-winning
mold manufacturer
relies on NX**

[video >](#)

Digitalizing end-to-end mold manufacturing

Haidlmair GmbH

SIEMENS
Ingenuity for life

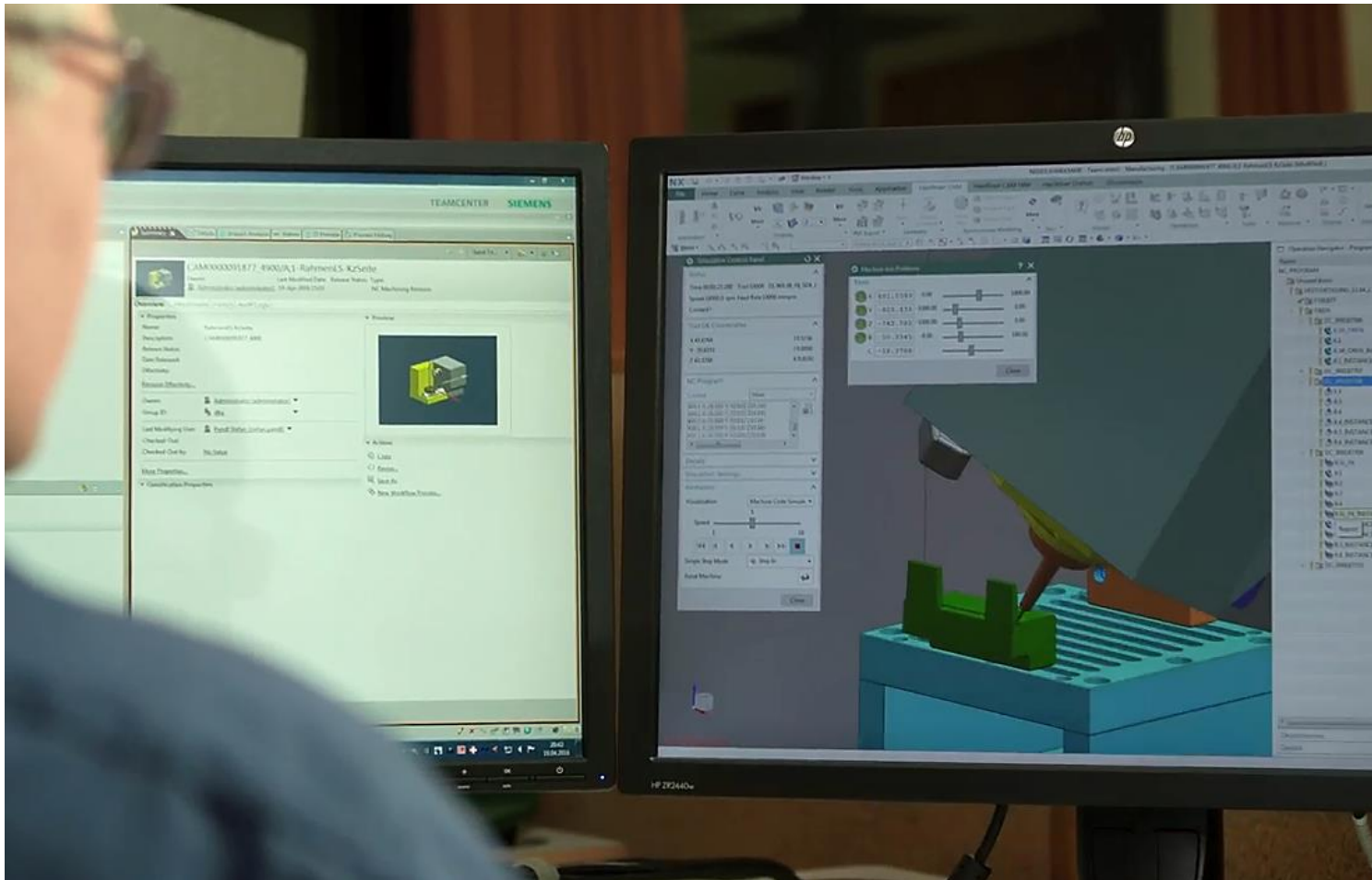

Transforming how
molds are made

[video >](#)

Additive manufacturing for Mold Inserts Toolcraft

SIEMENS
Ingenuity for life

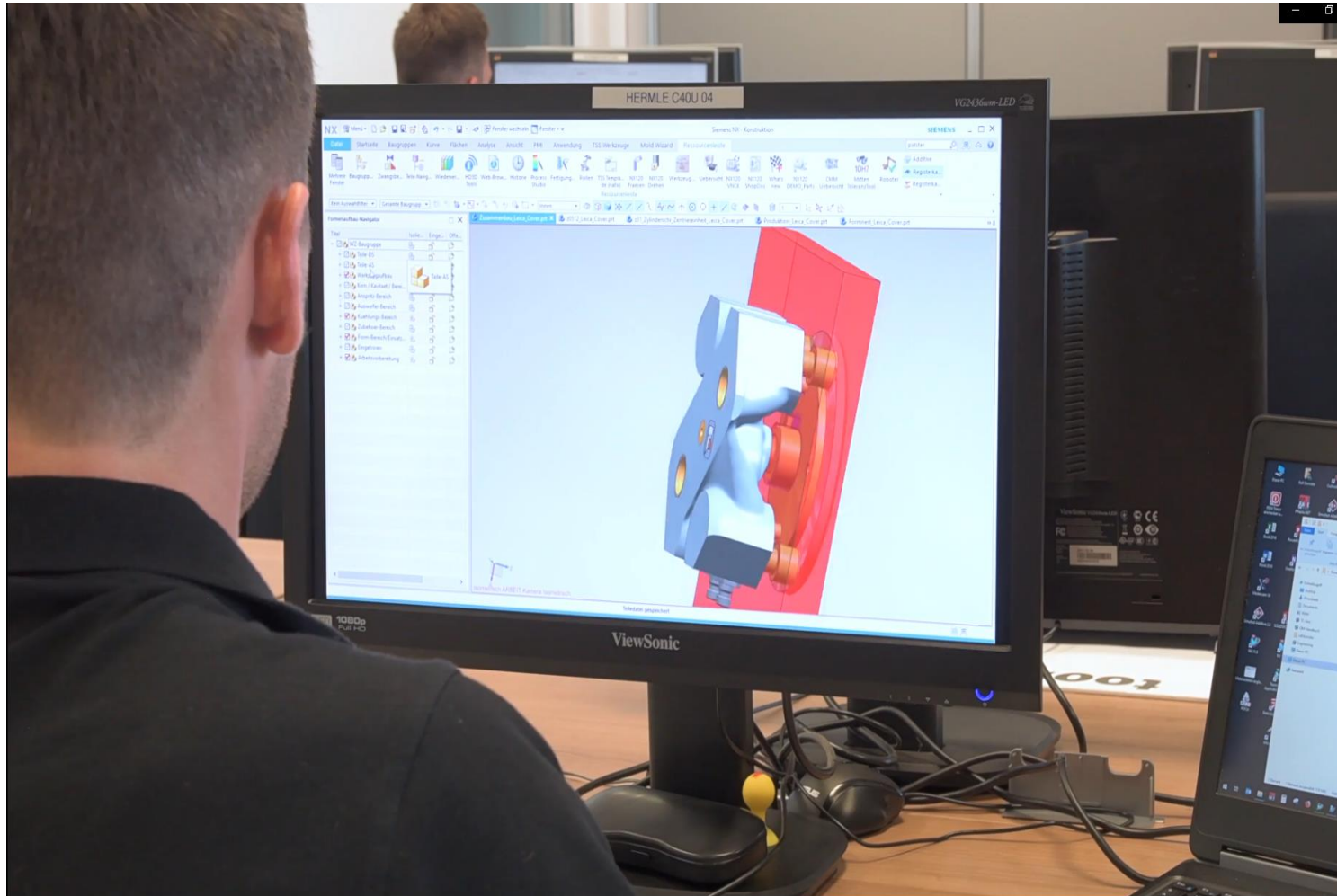

**30% reduction of
cycle time**

[video >](#)

Gain productivity using NX, an integrated tooling solution

Part Manufacturability: Control impact on downstream costs and time

Tool Design: Achieve high levels of productivity using automated processes

Tool Manufacturing: Automate CNC programming and machine high quality tooling



Our commitment to our customers

Siemens Digital Industries is the first major CAD/CAM/CAE vendor to offer its customers a continuous release process for new software versions

The NX team is committed to:

- Delivering quality releases that are easy to deploy
- Building solutions on the most modern architecture to protect your investment
- Our **historically proven** commitment to data compatibility



Thank you.